

VISTA 1

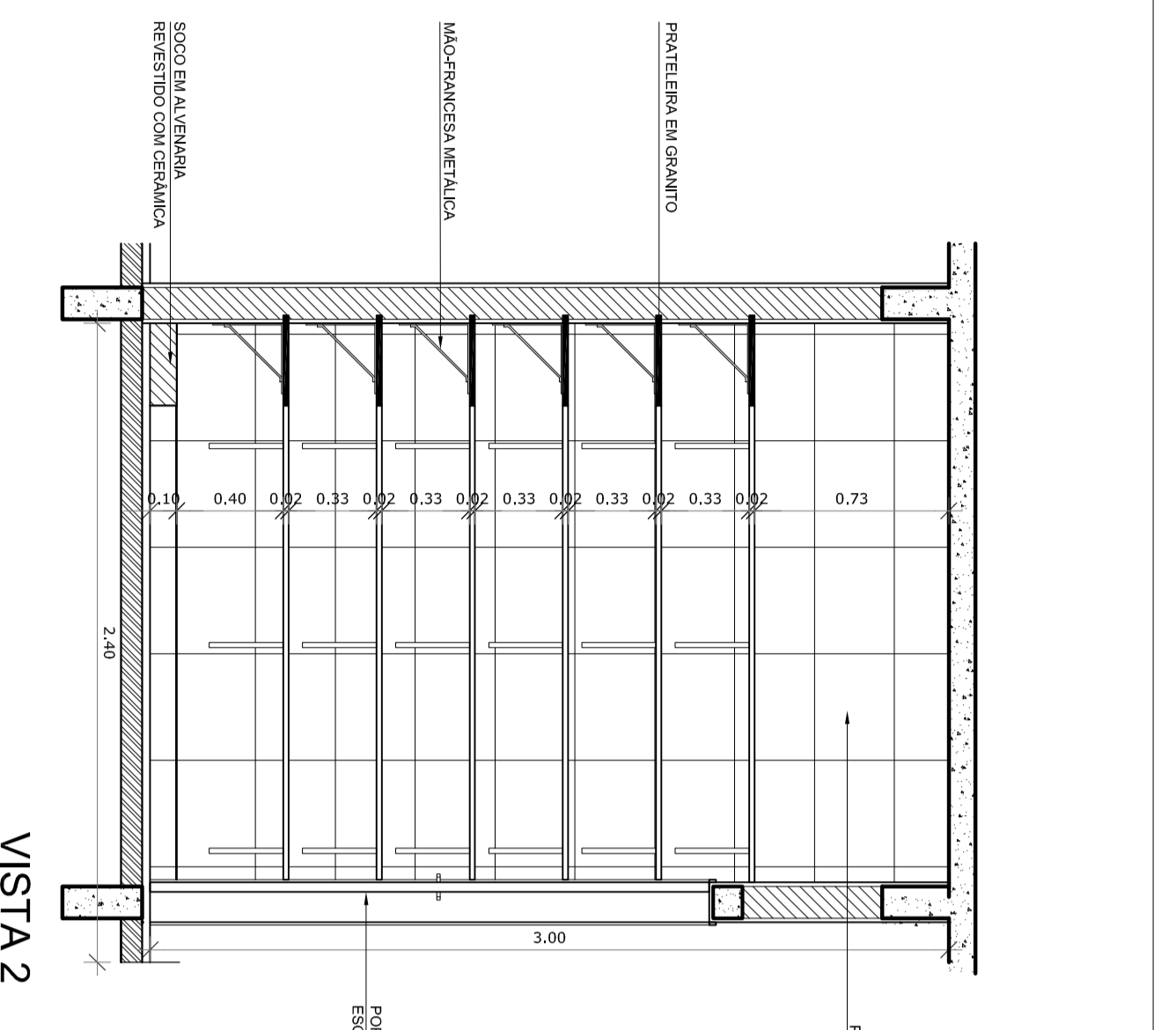

VISTA 2

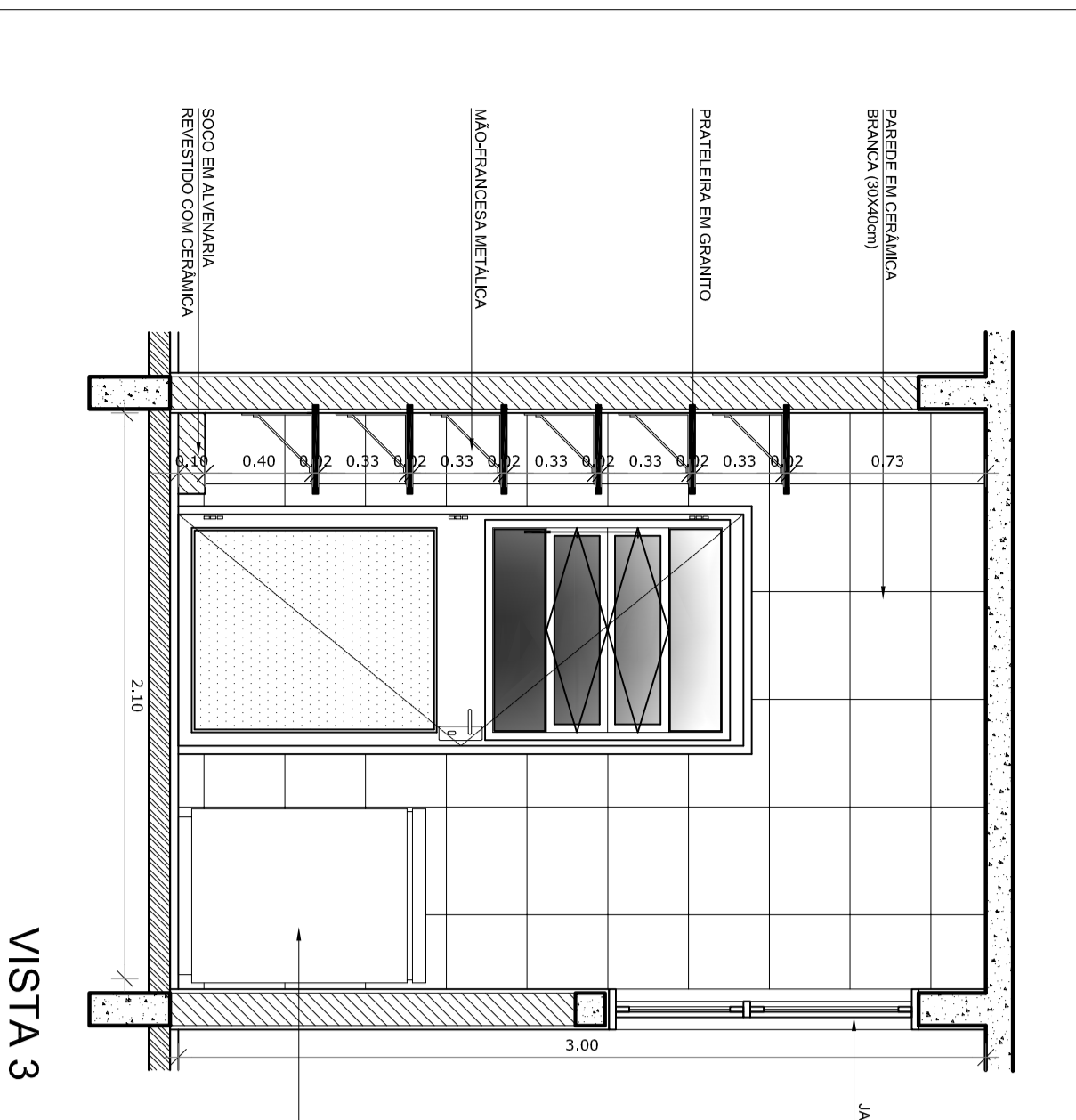

VISTA 3

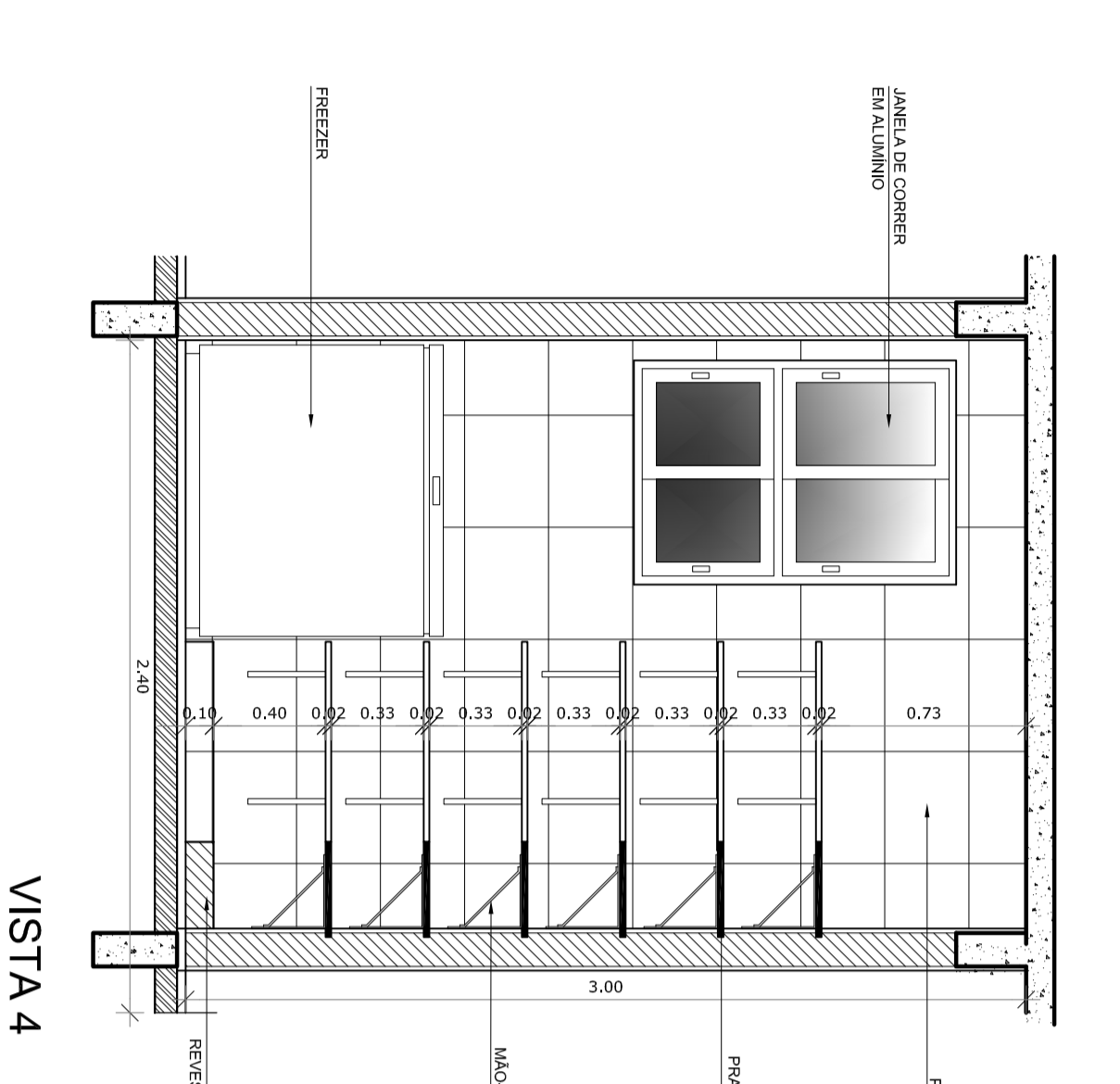

VISTA 4

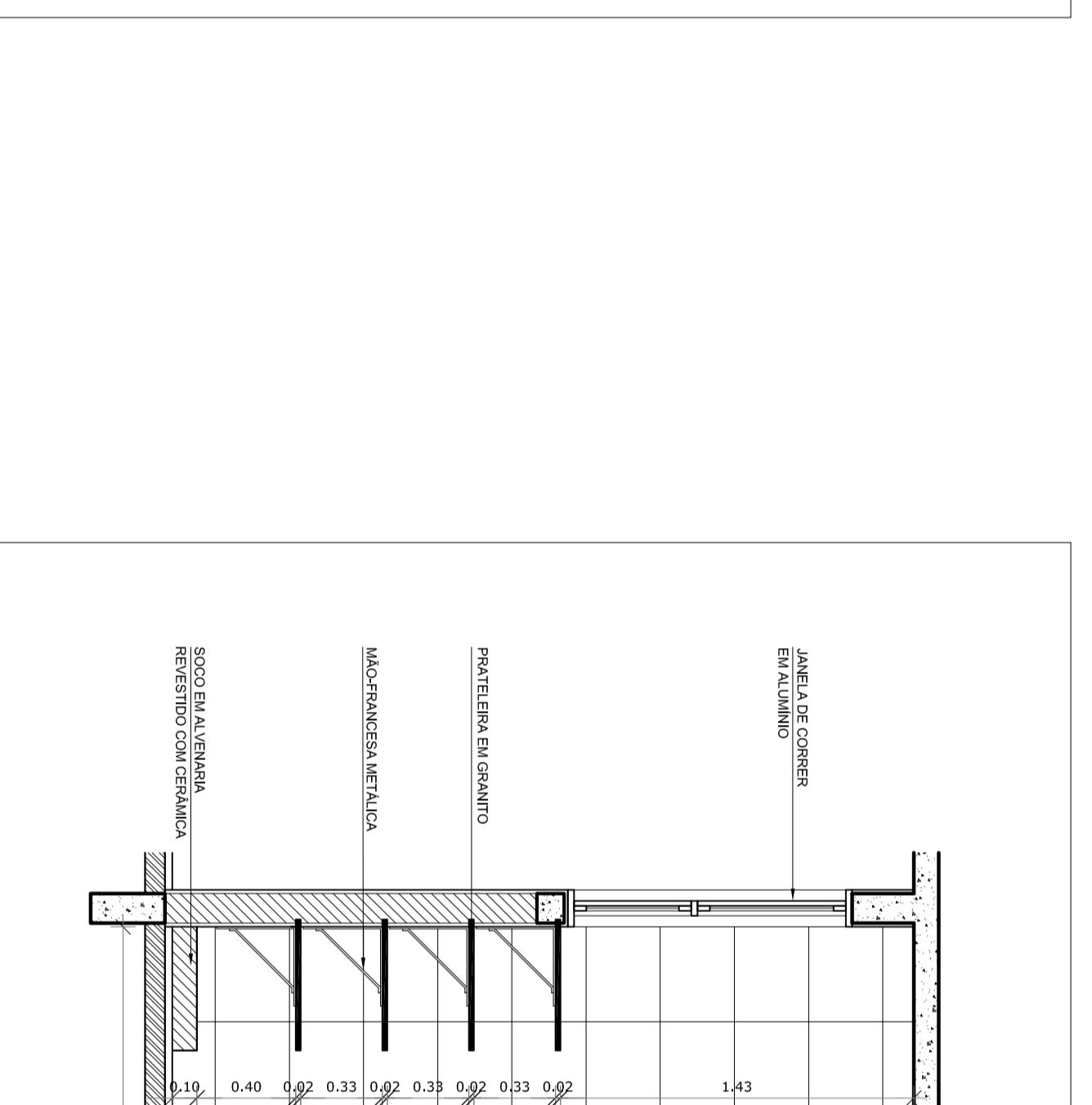

VISTA 1

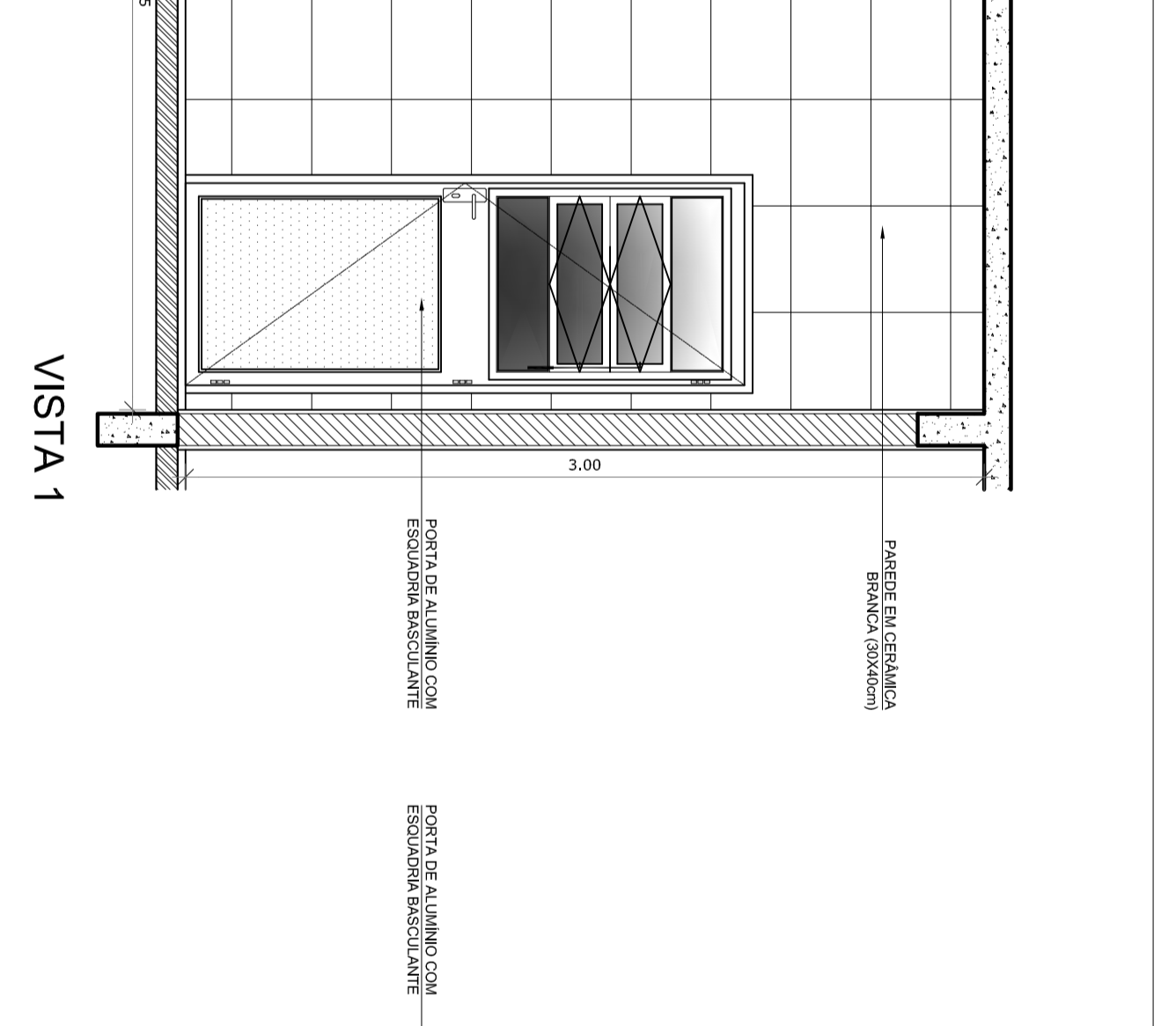

VISTA 2

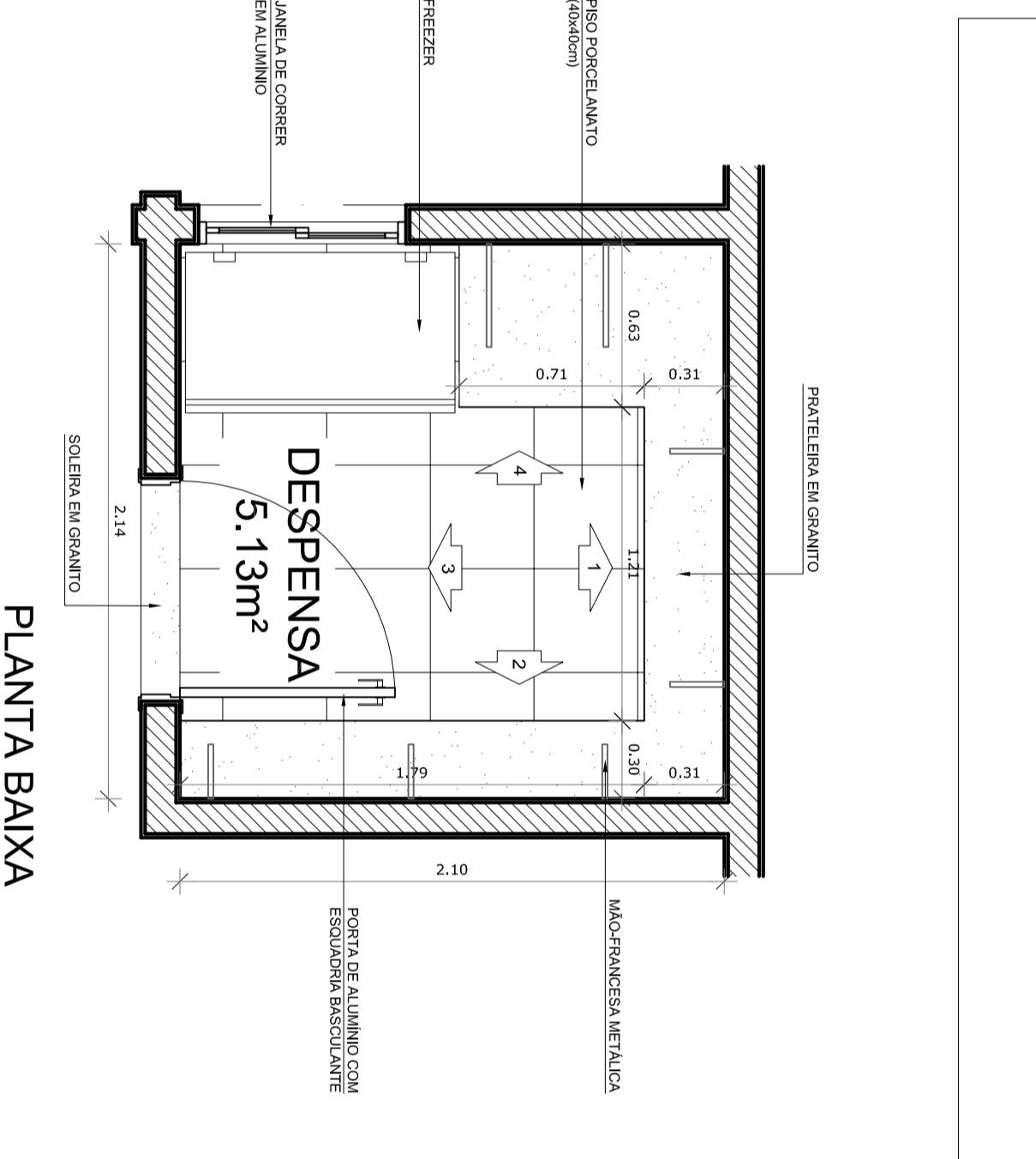

PLANTA BAIXA

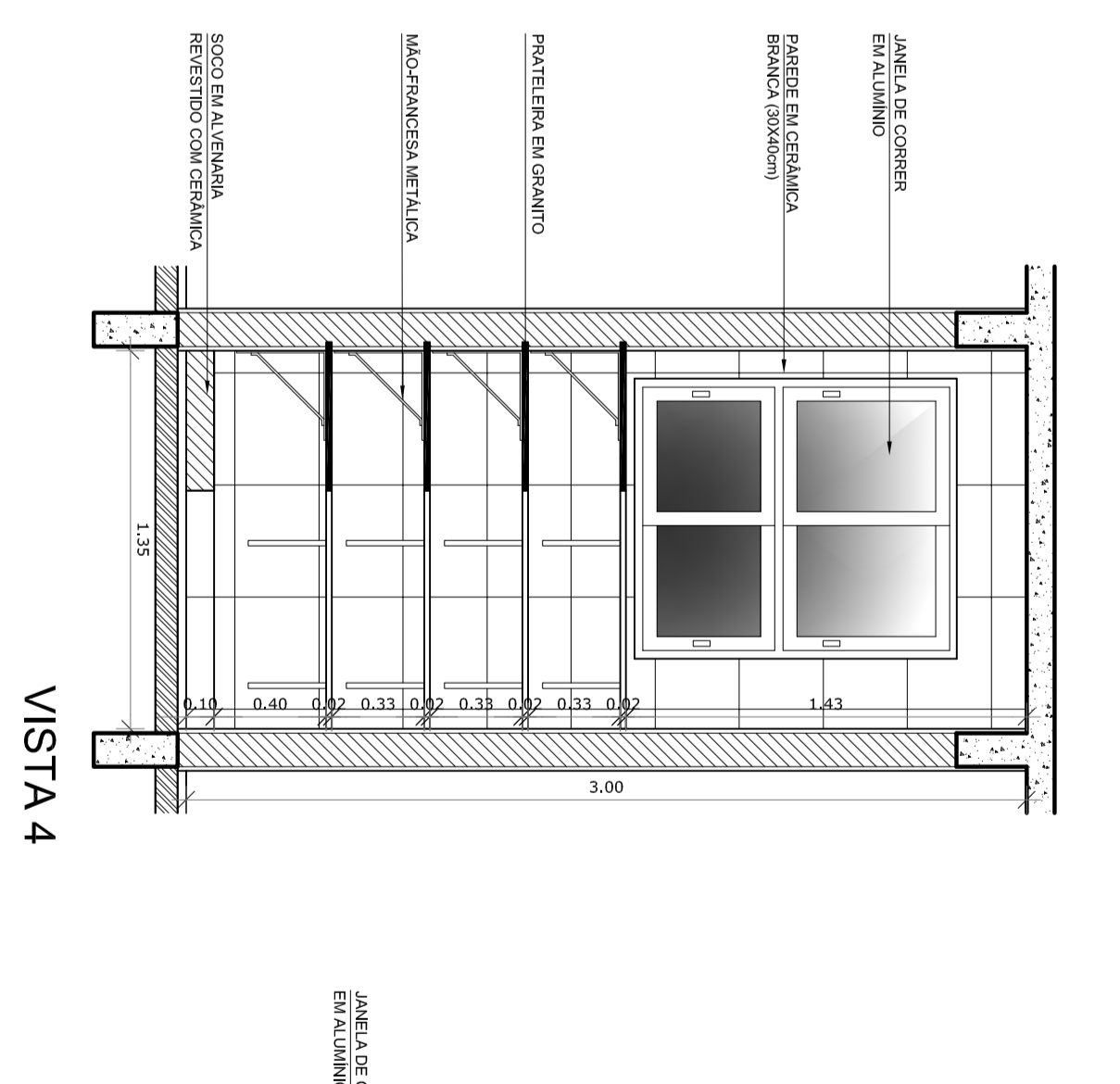

VISTA 4

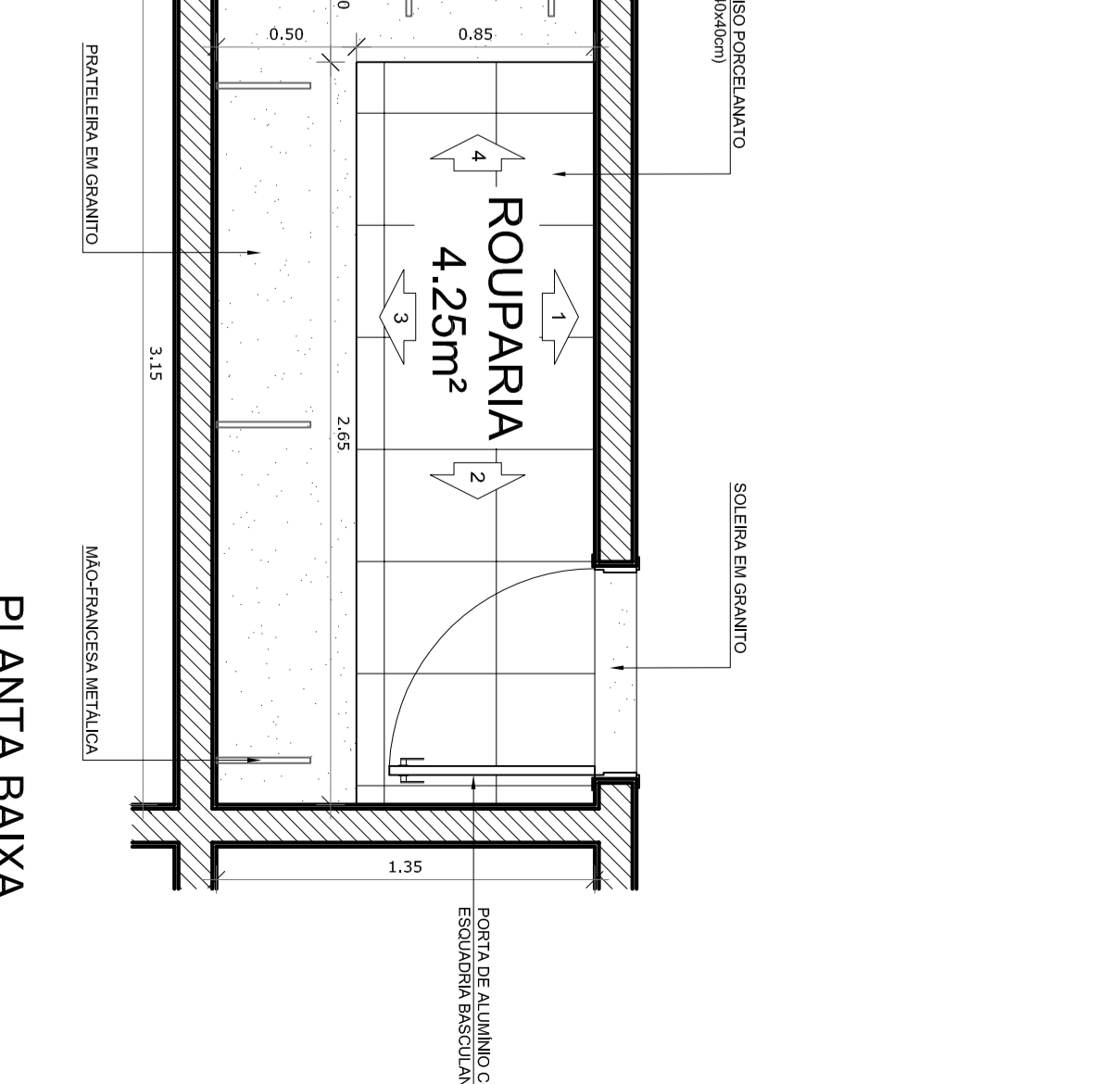

PLANTA BAIXA

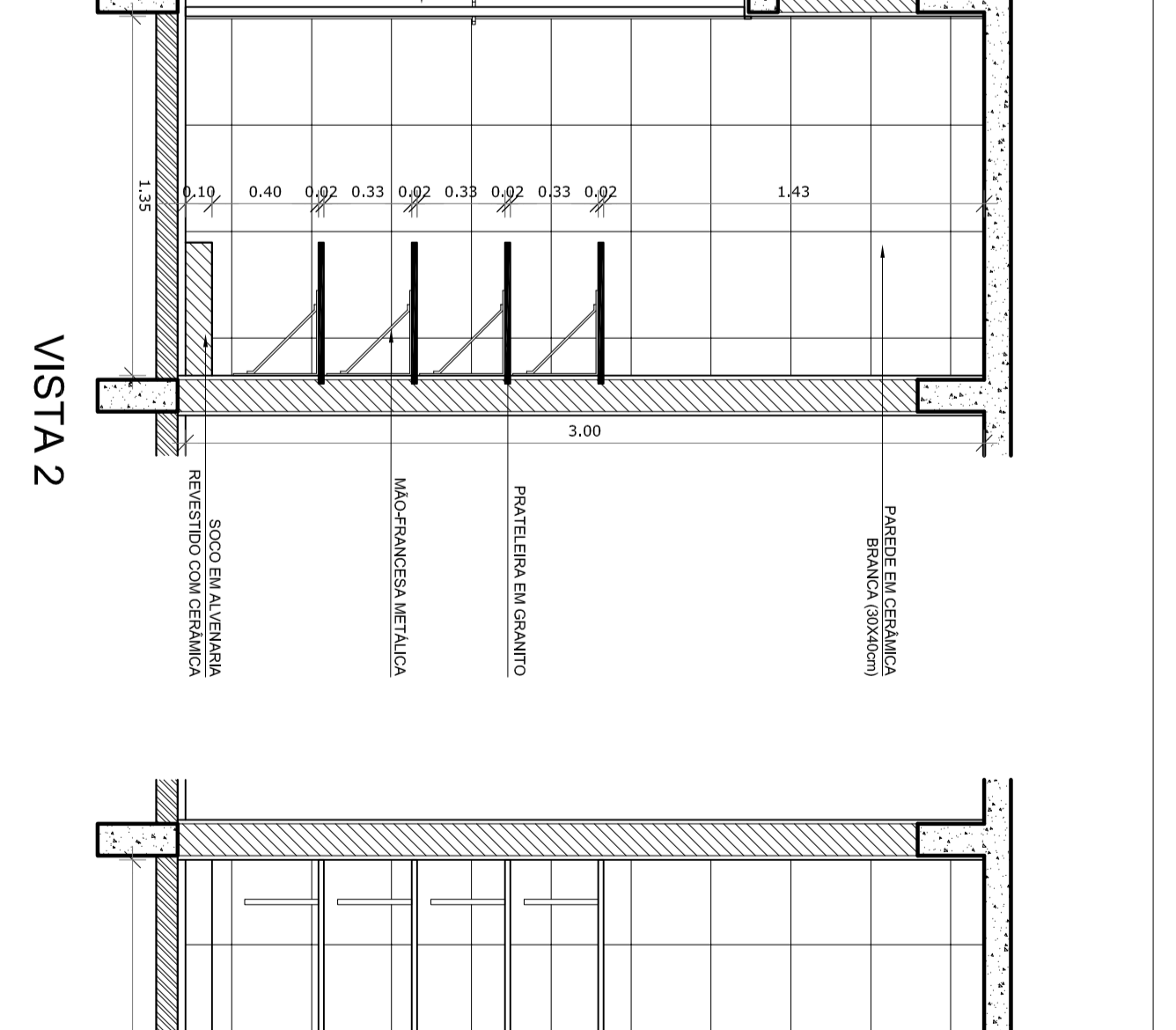

VISTA 2

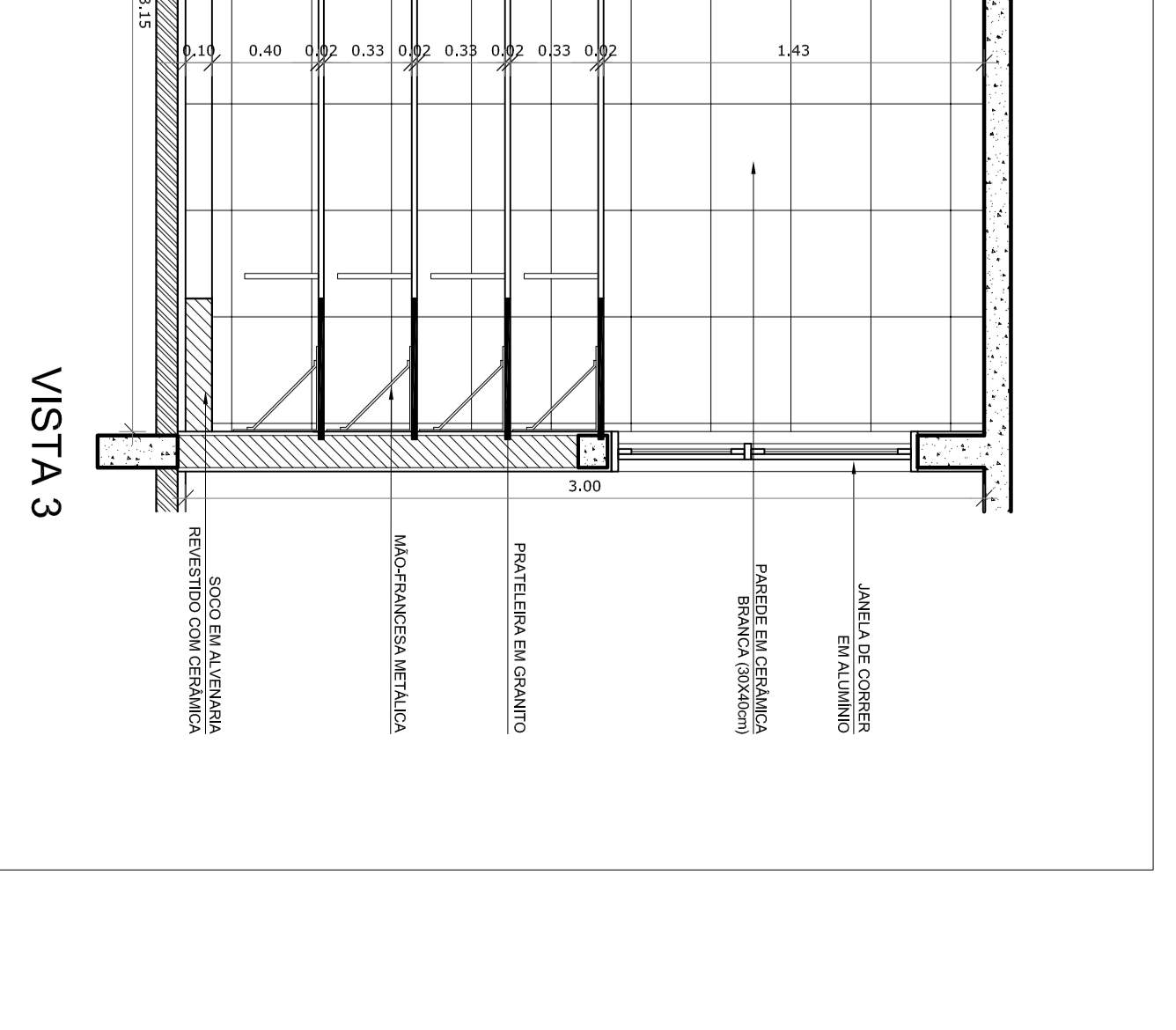

VISTA 3

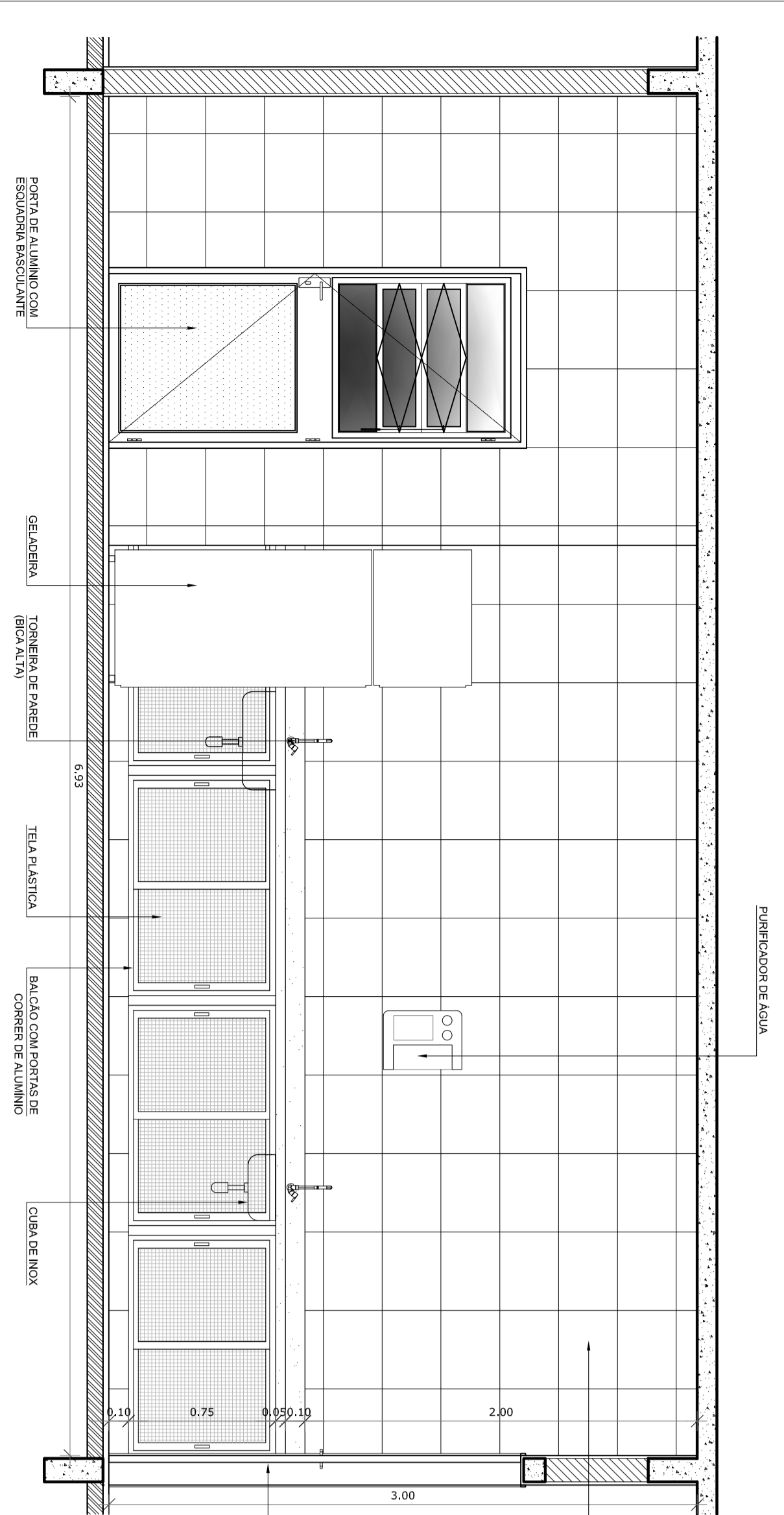

VISTA 1

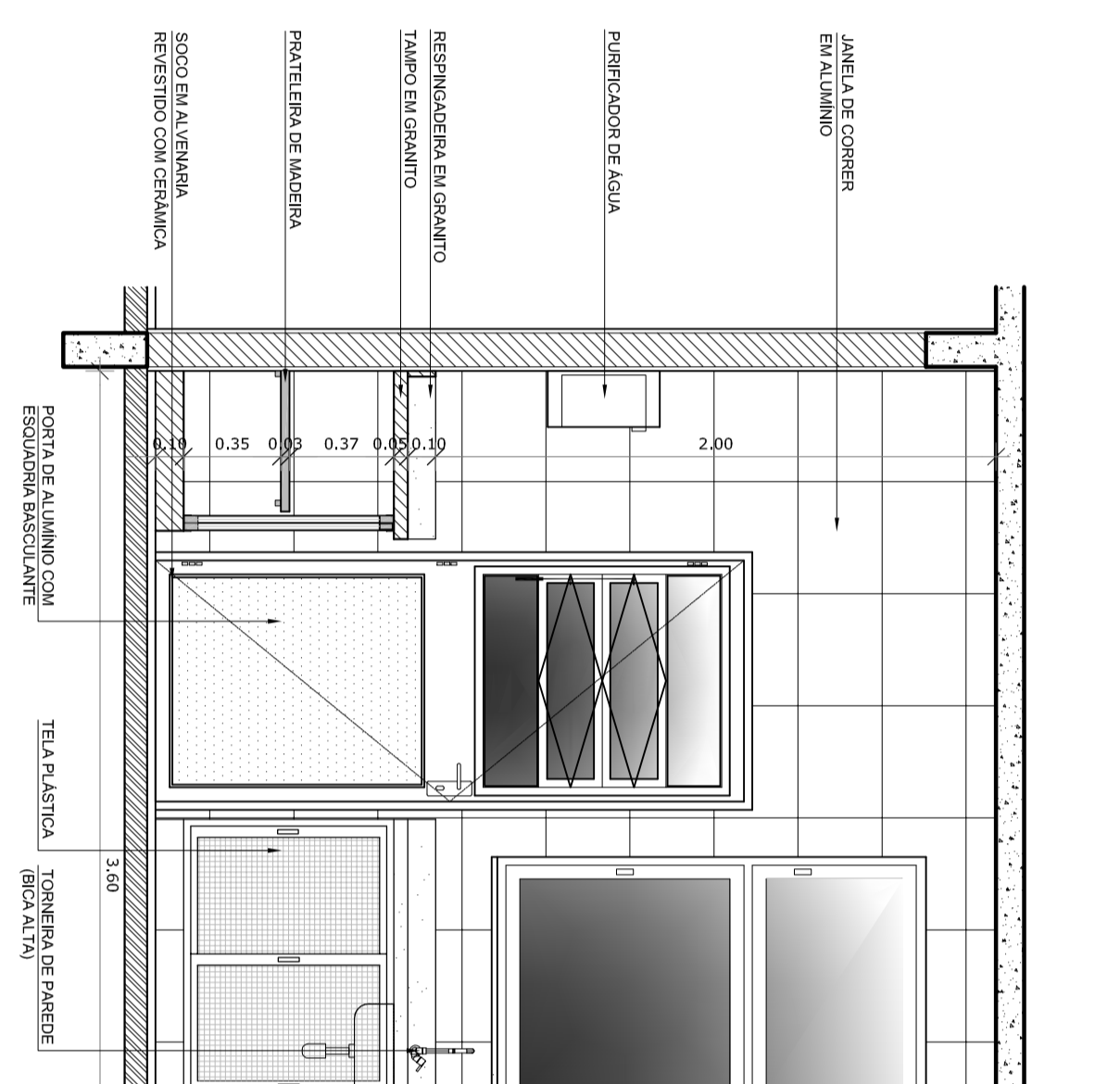

VISTA 2

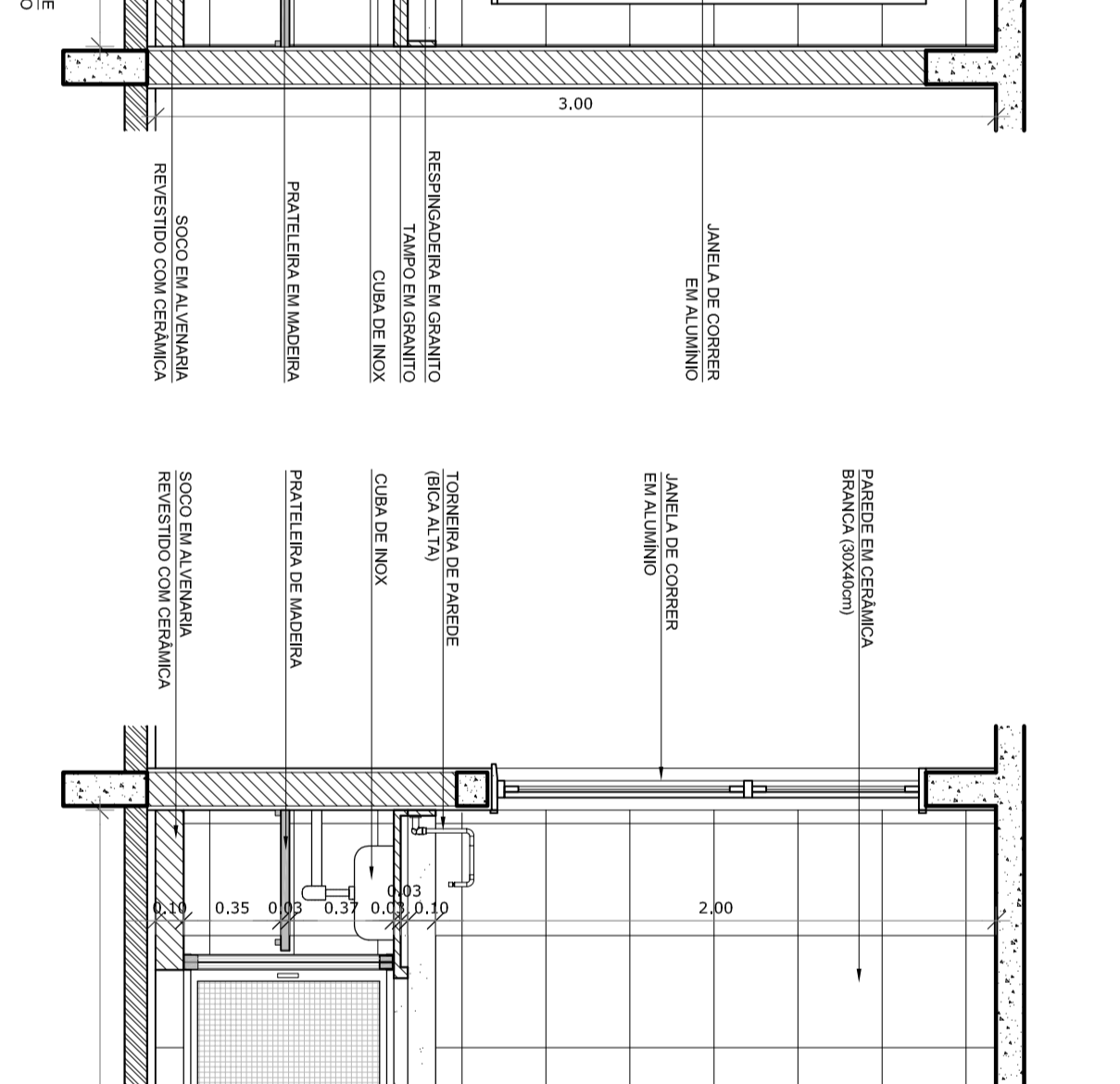

VISTA 3

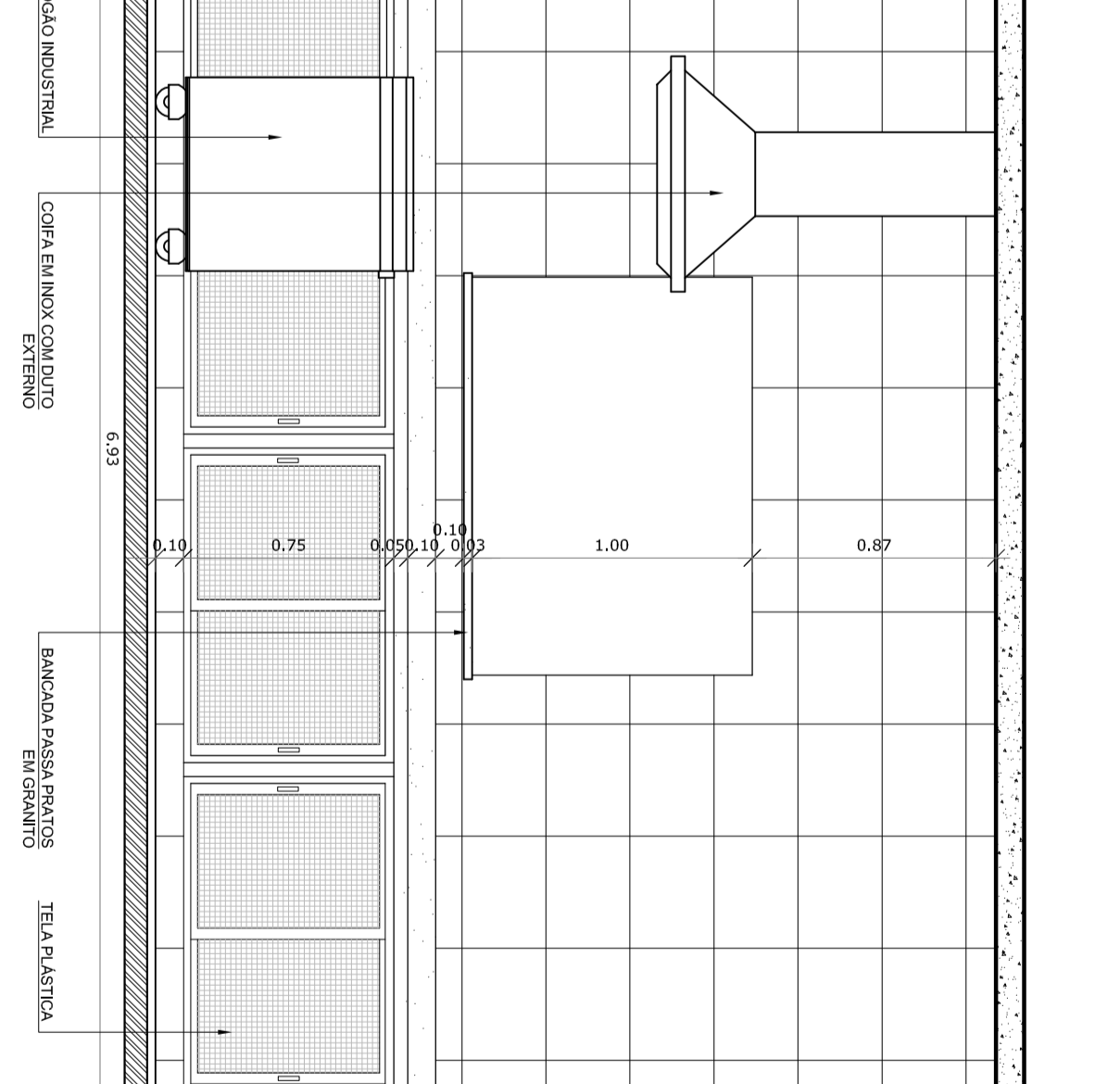

VISTA 1

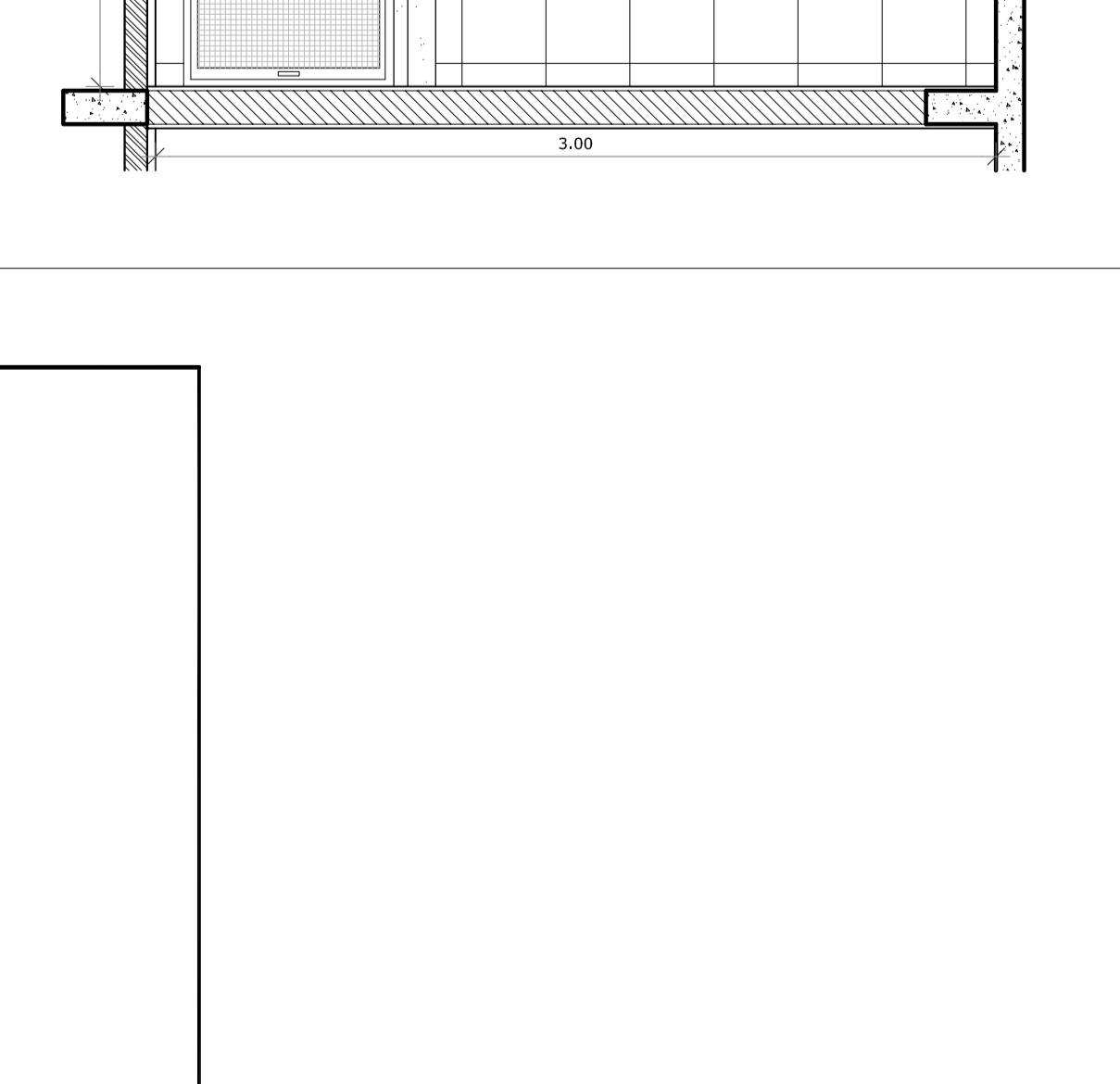

VISTA 2

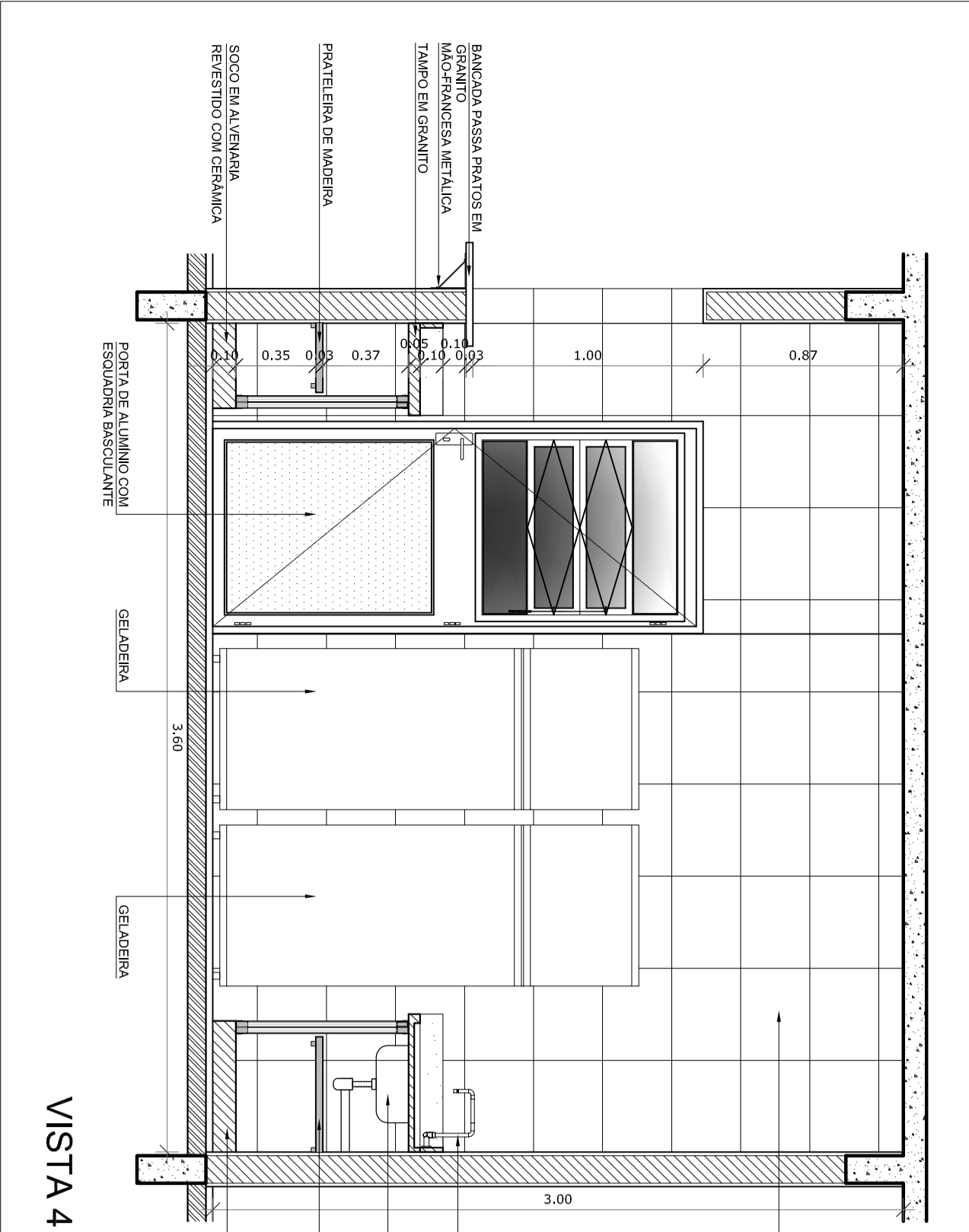

VISTA 4

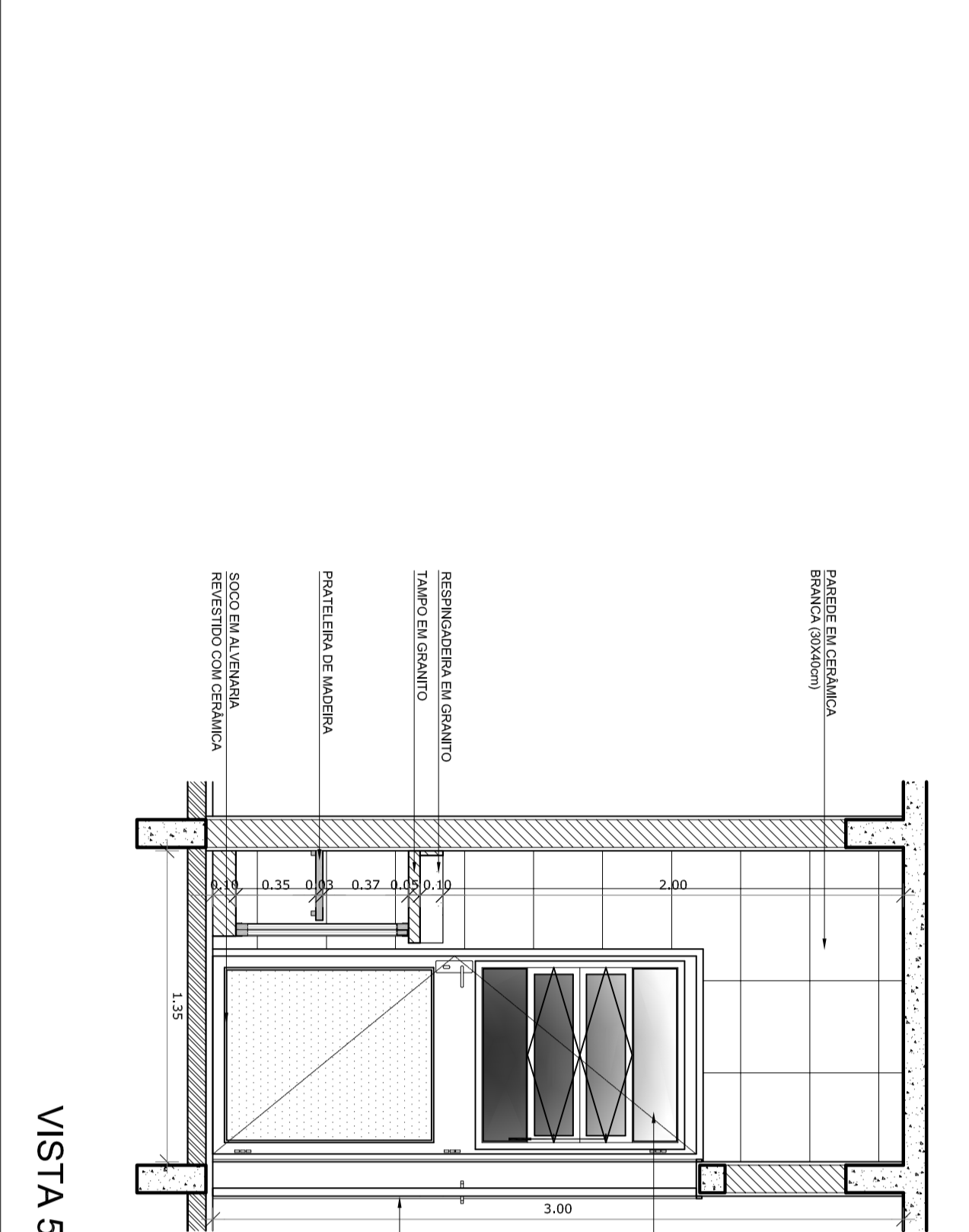

VISTA 5

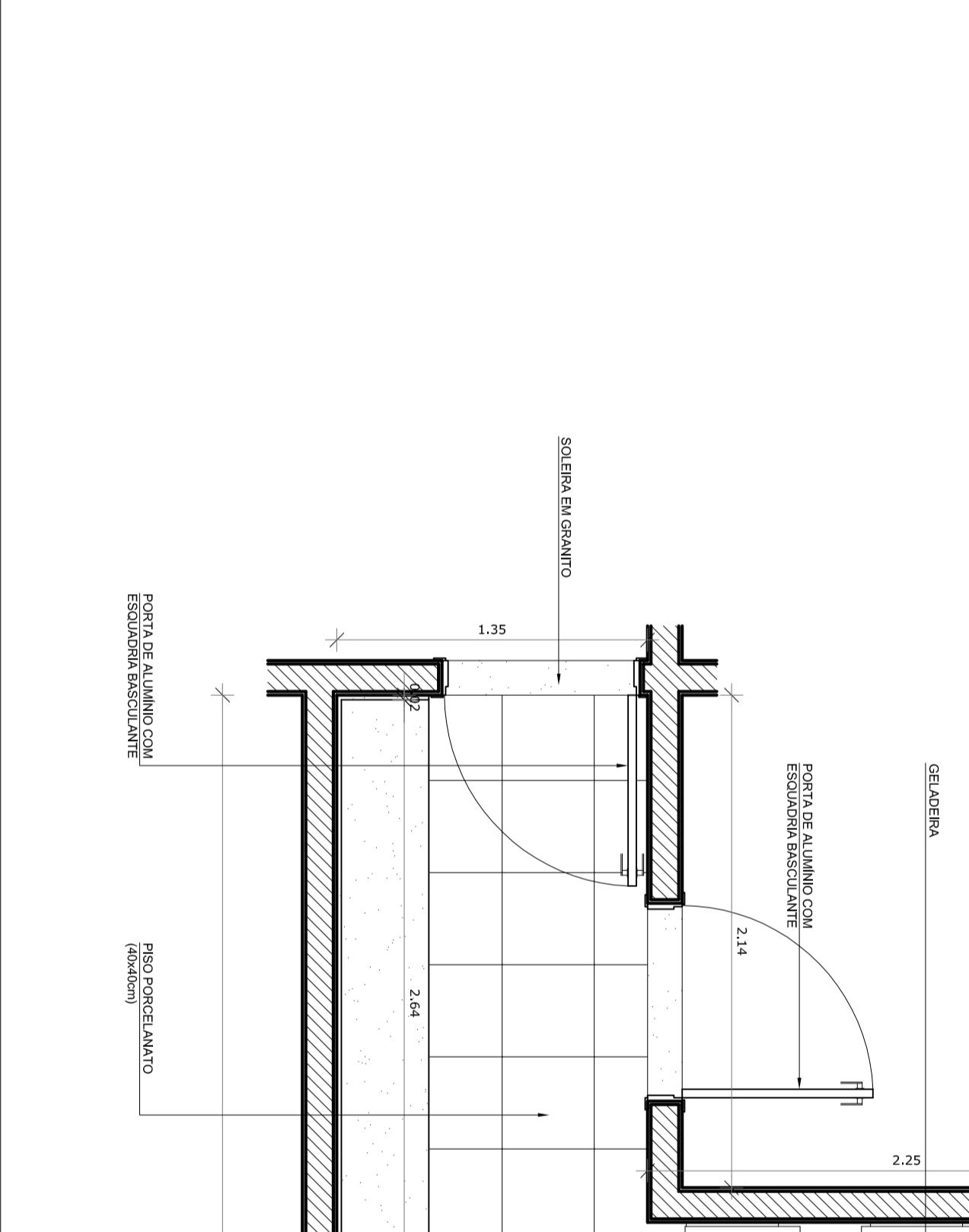

VISTA 1

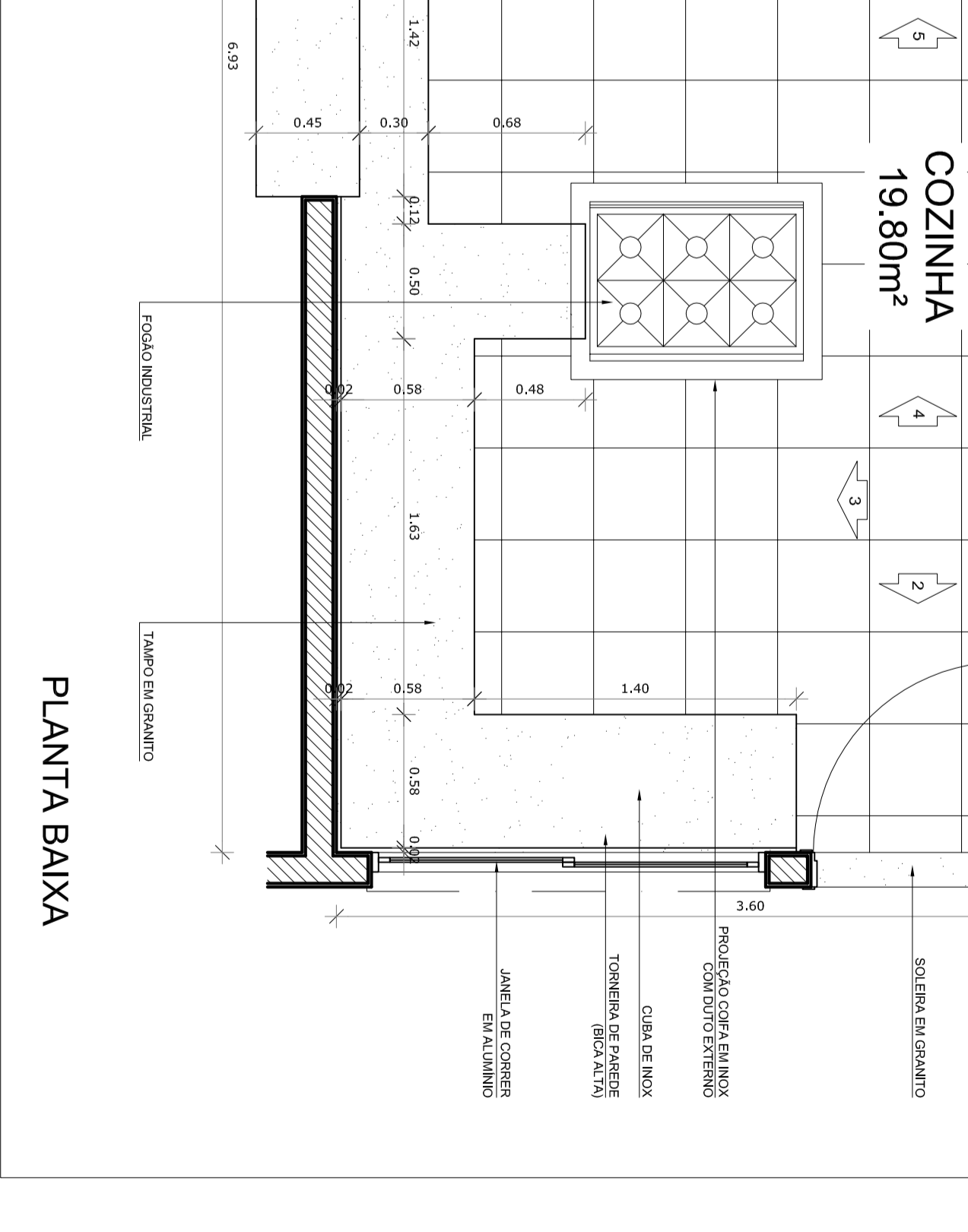

VISTA 2

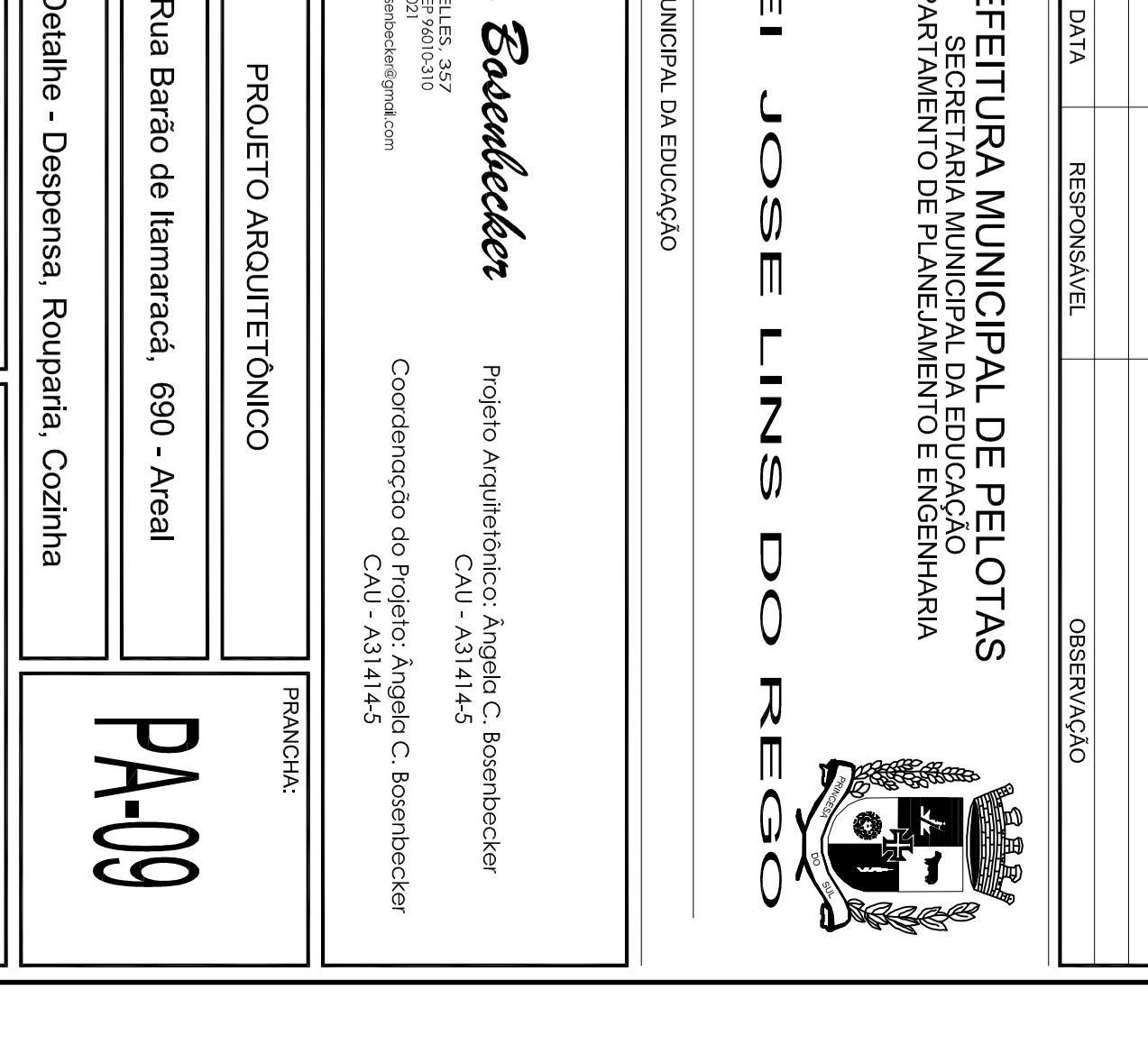

PLANTA BAIXA

EMEI JOSE LINS DO REGO
SECRETARIA MUNICIPAL DA EDUCAÇÃO

PROJETO
Huella Bauwacker
Rua Barão de Itamaracá, 690 - Areal
Detalhe - Despensa, Rouparia, Cozinha

PROJETO ARQUITETÔNICO
FRANZISK

PROJETO RESPONSÁVEL
Rogério Aquilino de Araújo C. Borenscheker
CAU - A514145
Coordenador do Projeto: Rogério C. Borenscheker
CAU - A514145

ENGENHEIRO
Rafael de Souza
CAU - A514145

LOCAL E DATA
Palmeiras, outubro de 2014.

ESCALA
1/25

PA-09